

White
SKU: SW10162
EAN: 4260754980942

Black
SKU: SW10161
EAN: 4260754980935

HIGH QUALITY

MADE IN GERMANY

**TABLE OF CONTENTS**

1.	PACKAGING CONTENT WARNING	3
2.	DIMENSIONS (mm)	4
3.	FLOW DIAGRAM	6
4.	RECOMMENDED DISTRO PLATE CONFIGURATION	7
5.	INSTALLING THE D5 OR DDC PUMP	8
6.	INSTALLING THE DISTROBUTION PLATE	10
7.	CONNECTING THE D-RGB CABLE	12
8.	INSTALLING THE CONNECTIONS	12
9.	CLEANING & CARE	12
10.	SUPPORT AND SERVICE	12

1. PACKAGING CONTENT WARNING

This product is intended for advanced users. Improper installation may result in damage to your equipment. While every effort has been made to provide the most comprehensive information possible, Stealkey Customs assumes no liability, express or implied, for damage to your components resulting from the use of Stealkey Customs cooling products, whether due to errors or omissions on our part in the instructions below, or due to errors or defects in Stealkey Customs cooling products. Do not disassemble the distro plate. Doing so will void the warranty. Turn off your system and discharge your body's static charge before proceeding with the installation. If you do not feel comfortable performing the installation procedure, contact a qualified computer technician.

SK-Crosscool III Lian Li O11 DYNAMIC EVO RGB Distroplate D-RGB

Black

SKU: SW10161

EAN: 4260754980935

White

SKU: SW10162

EAN: 4260754980942

Mounting screws

6x M3x4 mm

Plugs

9x G1/4 Plugs

RGB

1x D-RGB Stripe

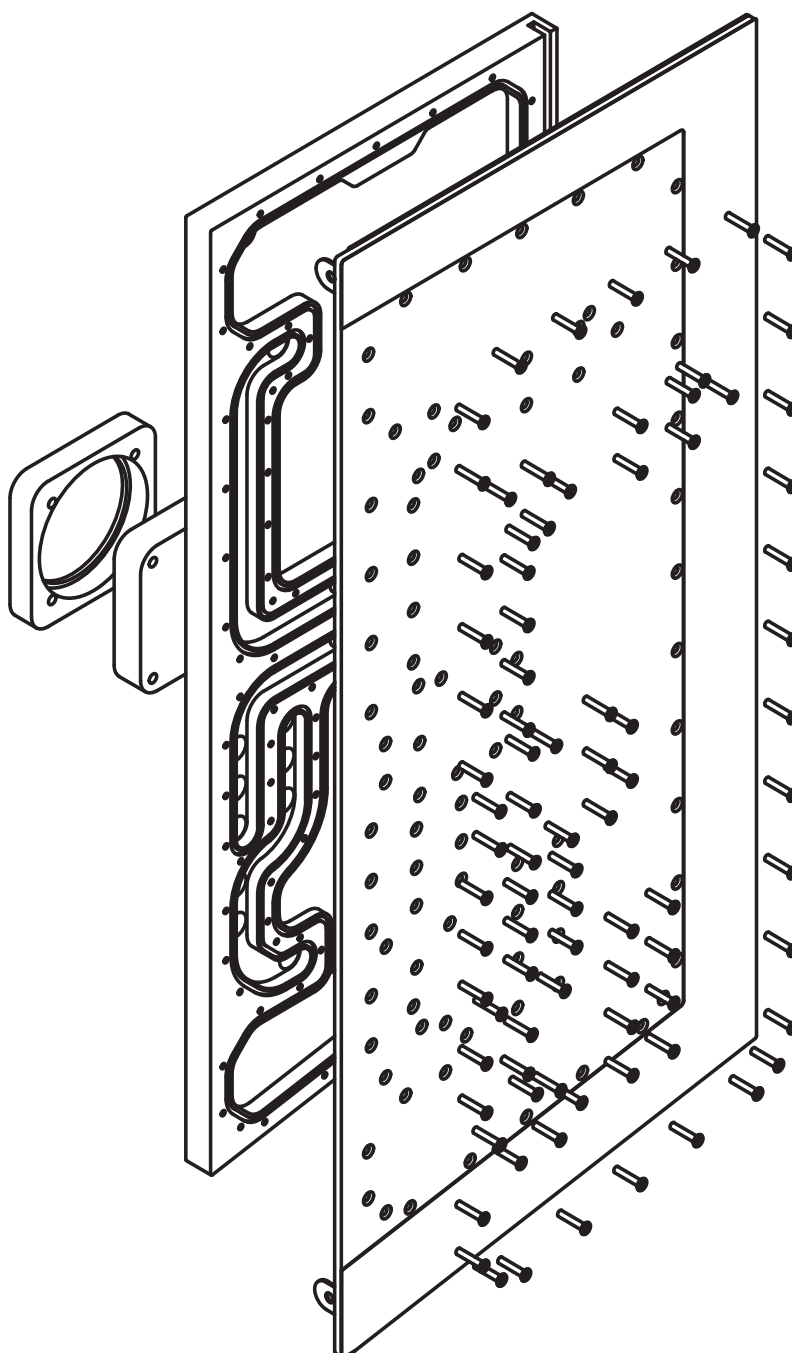

2. DIMENSIONS (mm)

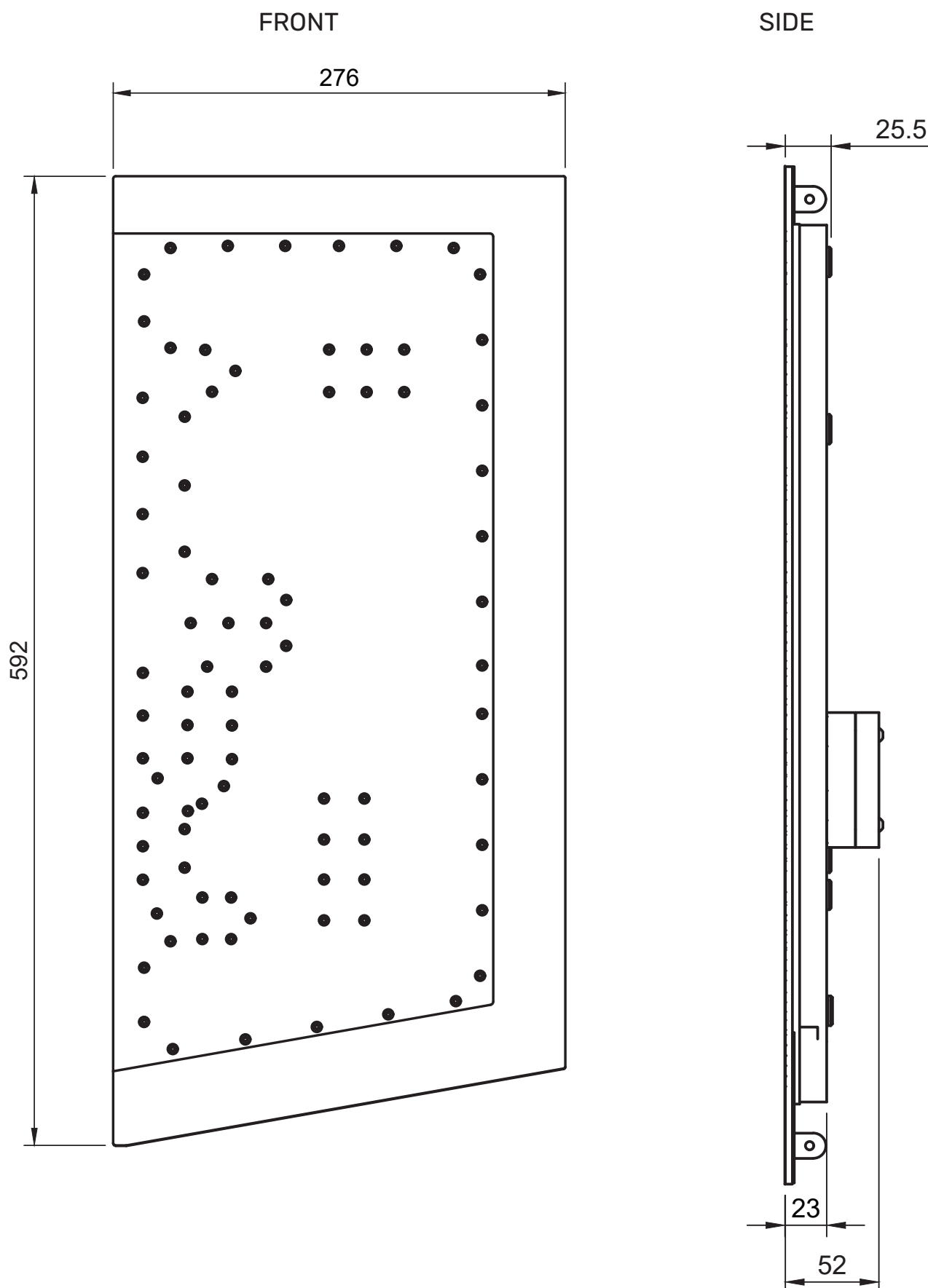



BACK

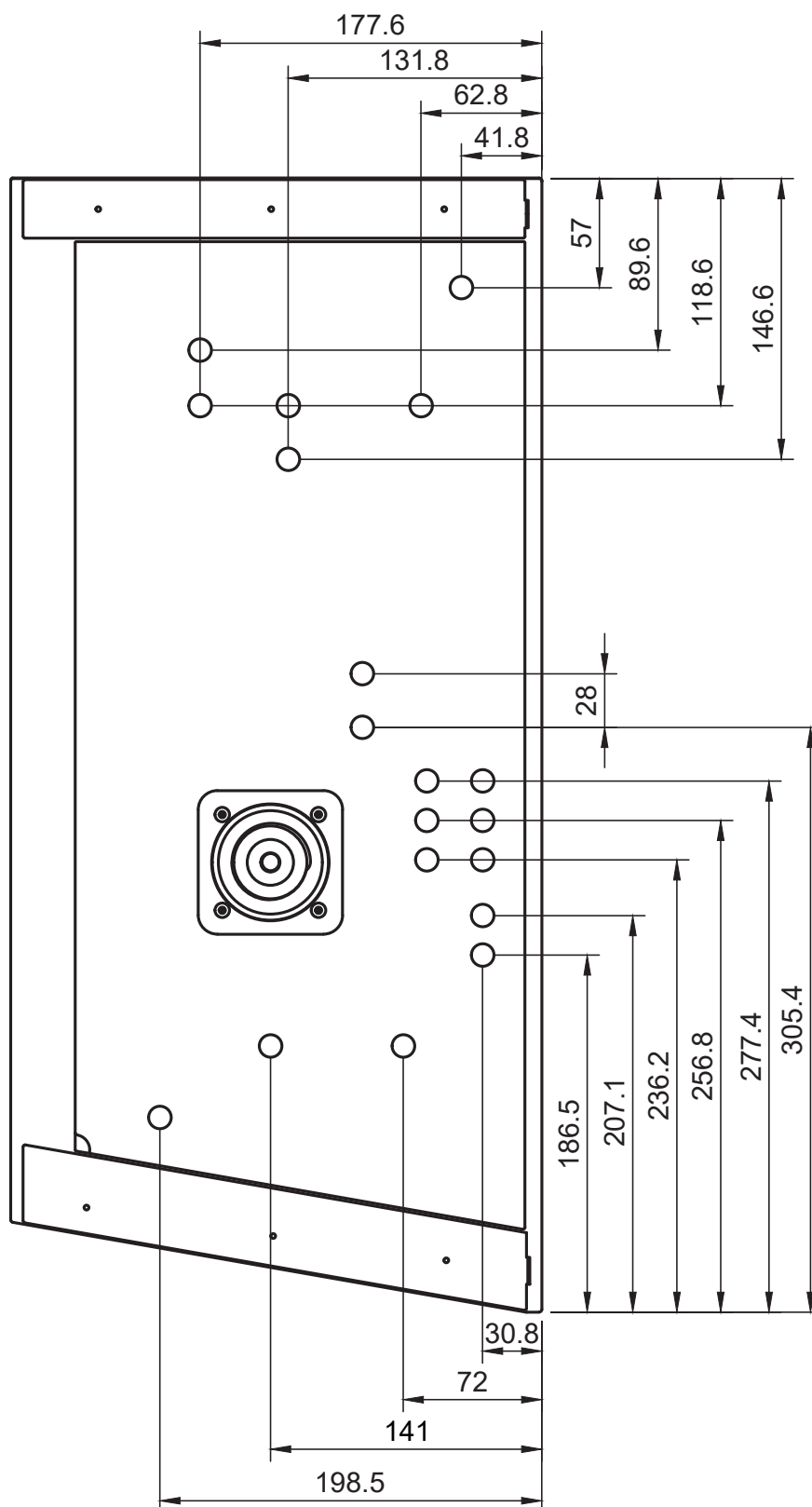

Phanteks NV9 x Stealkey Distroplate D-RGB

3. FLOW DIAGRAM

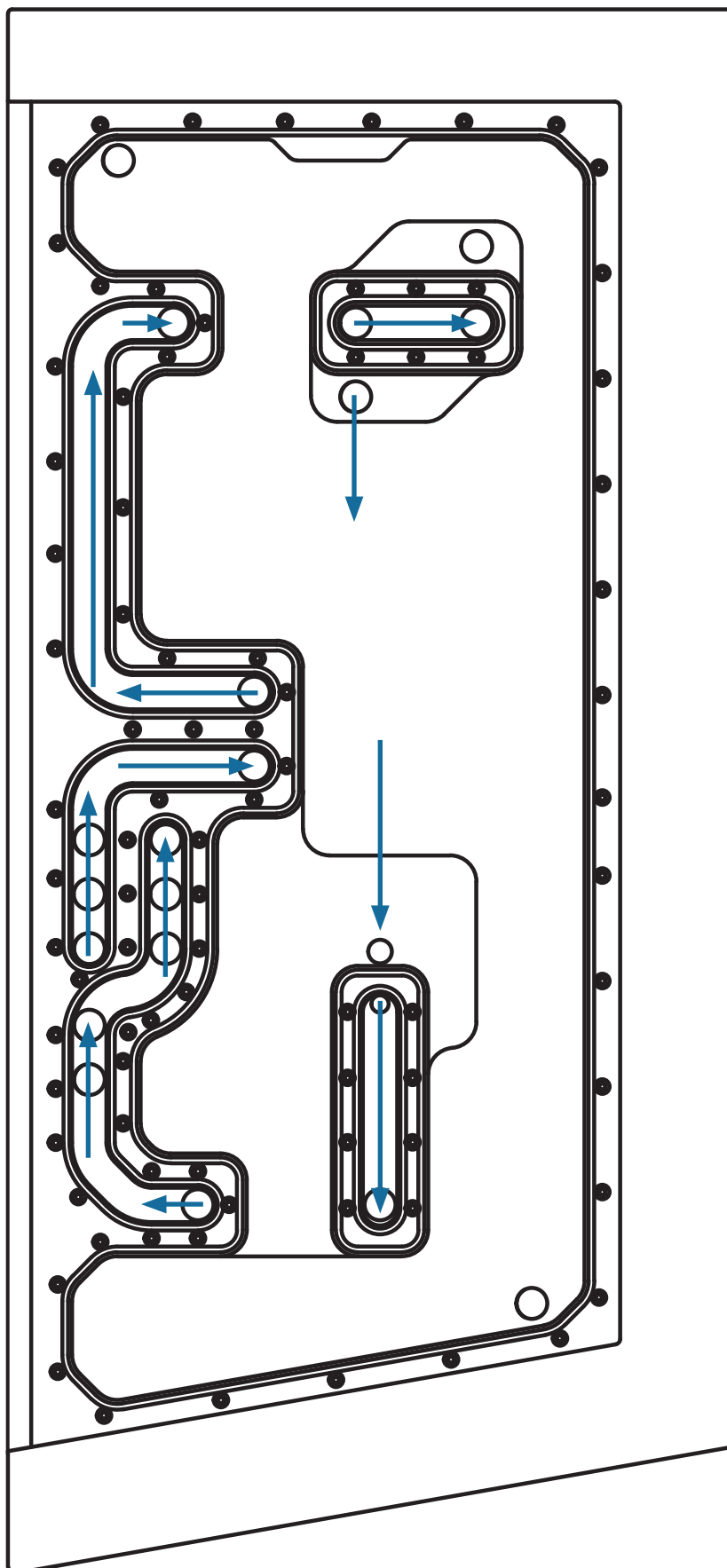

4. RECOMMENDED DISTRO PLATE CONFIGURATION

A configuration with 3 radiators is shown here. Close any unused ports with the provided plugs.

BACK VIEW

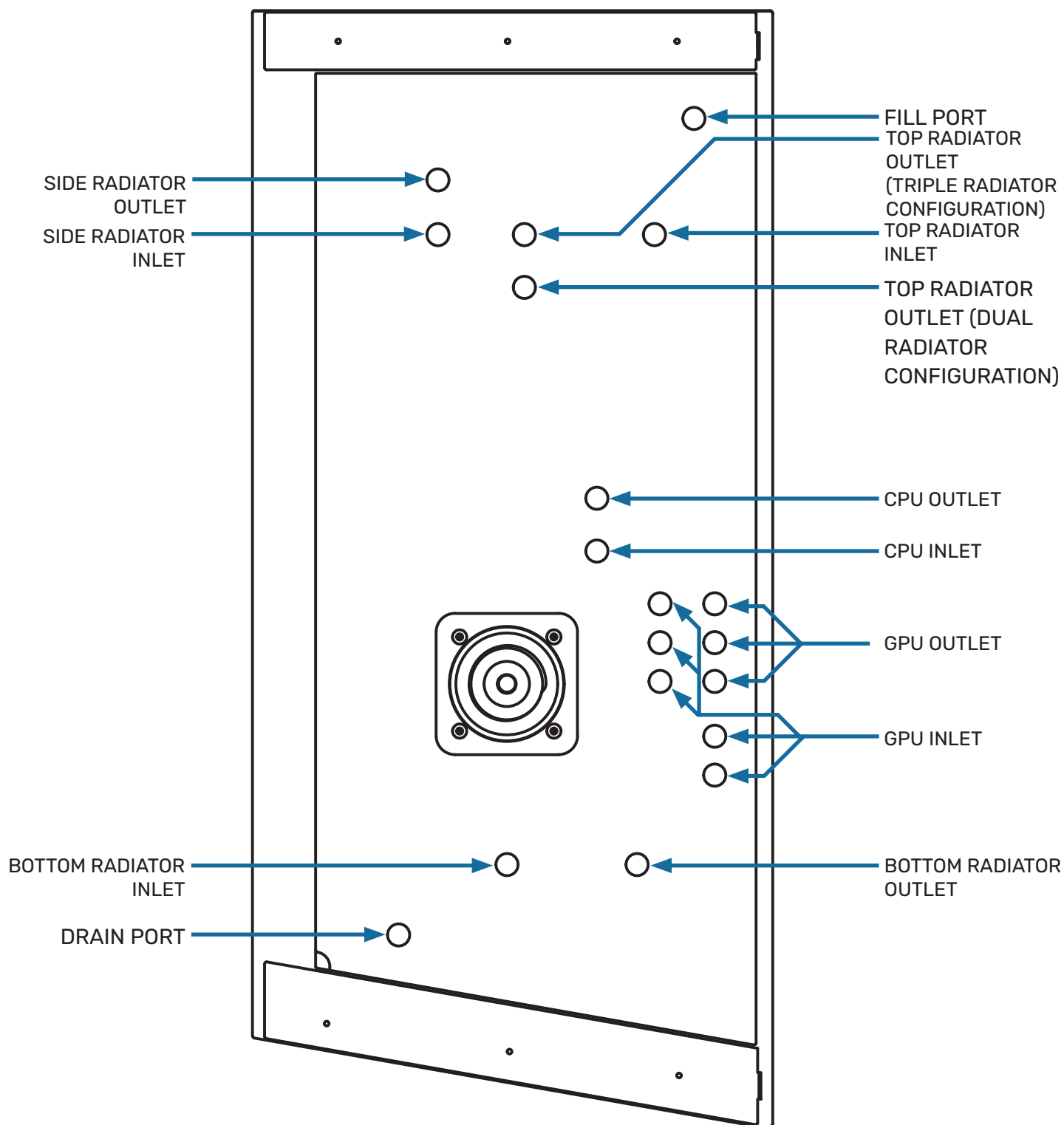

5. INSTALLING THE D5 OR DDC PUMP

STEP 1

Remove the 4x M4 x 20 mm screws (2,5 mm hexagon socket). Set the screws aside as they will be needed to secure the pump.

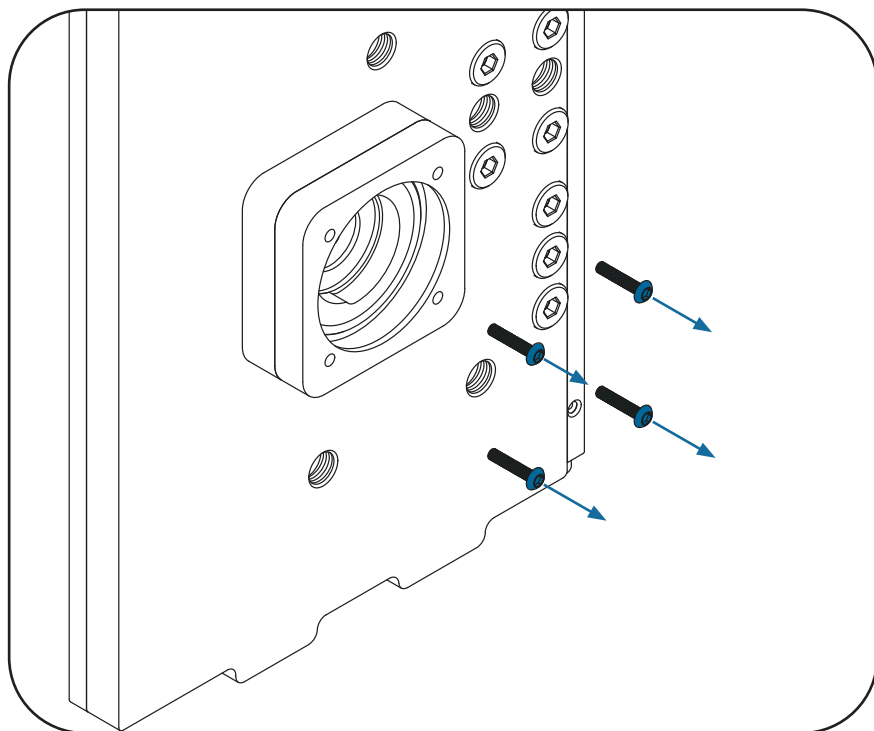

STEP 2

Now remove the D5 ring.

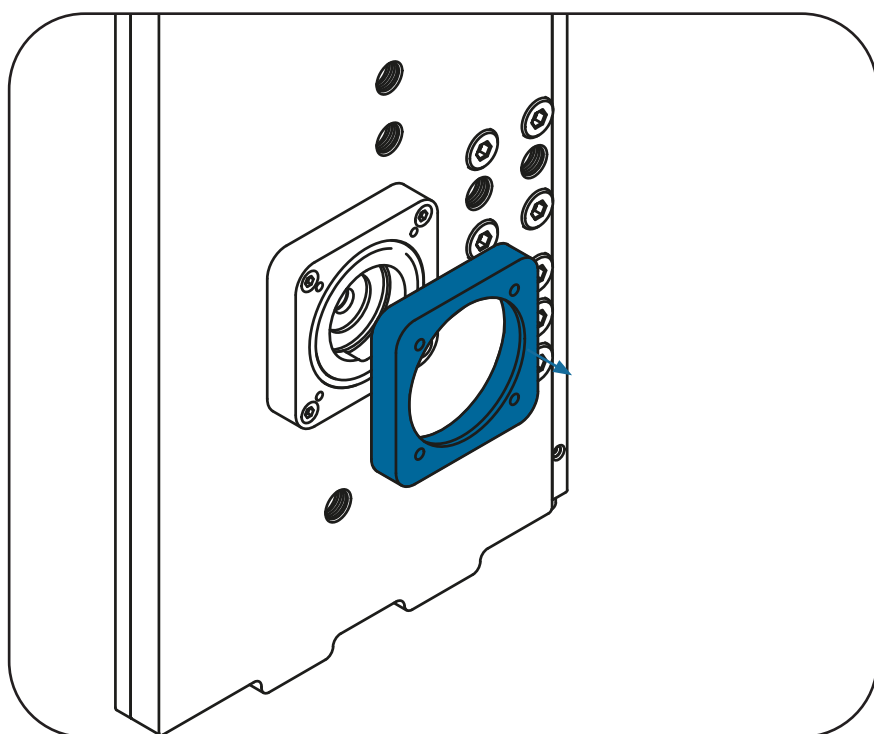

STEP 3

Installing the D5 pump. Place the D5 ring over the pump. Make sure the supplied o-ring is in the nut before installing the pump through the d5 ring on the adapter. Tighten the screws with 0,3 - 1,5 Nm. Handle with care when tightening.

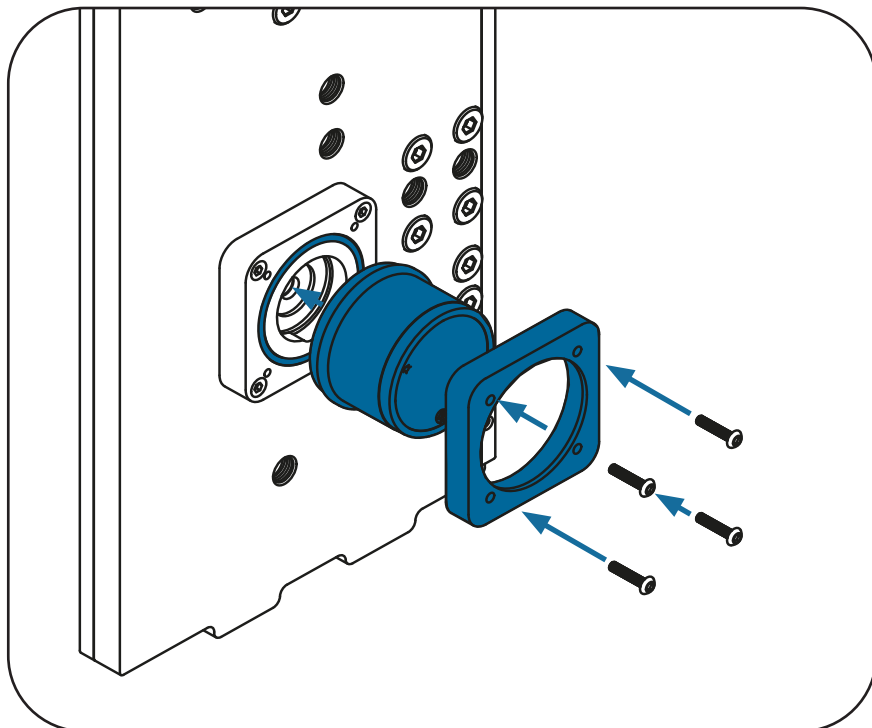

Cross-tighten screws for stress-free installation to avoid cracks in the acrylic glass.

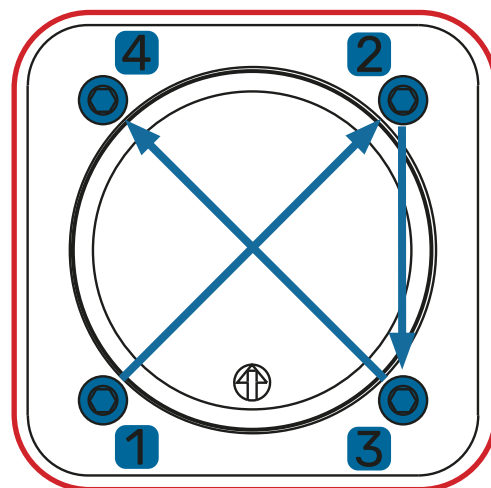

STEP 3.1

Installing the DDC pump. Do not use the D5 ring. Note that the D5 o-ring is not suitable for the DDC. Use the o-ring of the DDC pump. Place the pump on the adapter. Use M4 x 25 mm hexagon socket screws (not included in the scope of delivery). Tighten the screws with 0,5 - 1,5 Nm.

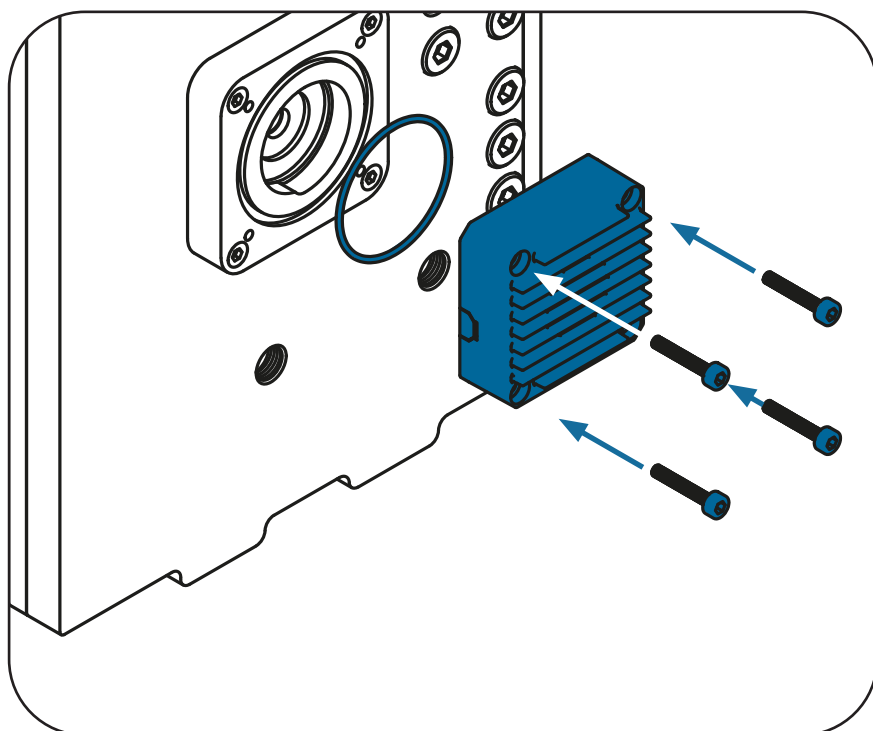

Cross-tighten screws for stress-free installation to avoid cracks in the acrylic glass.

6. INSTALLING THE DISTRIBUTE PLATE

STEP 1

Removing the original front panel:

First, remove the two screws located at the top and bottom of the front panel. Then carefully slide the front panel out to the side.

STEP 2

Now loosen the six M3 cylinder head screws at the top and bottom of the bracket by approximately 1-2 mm.

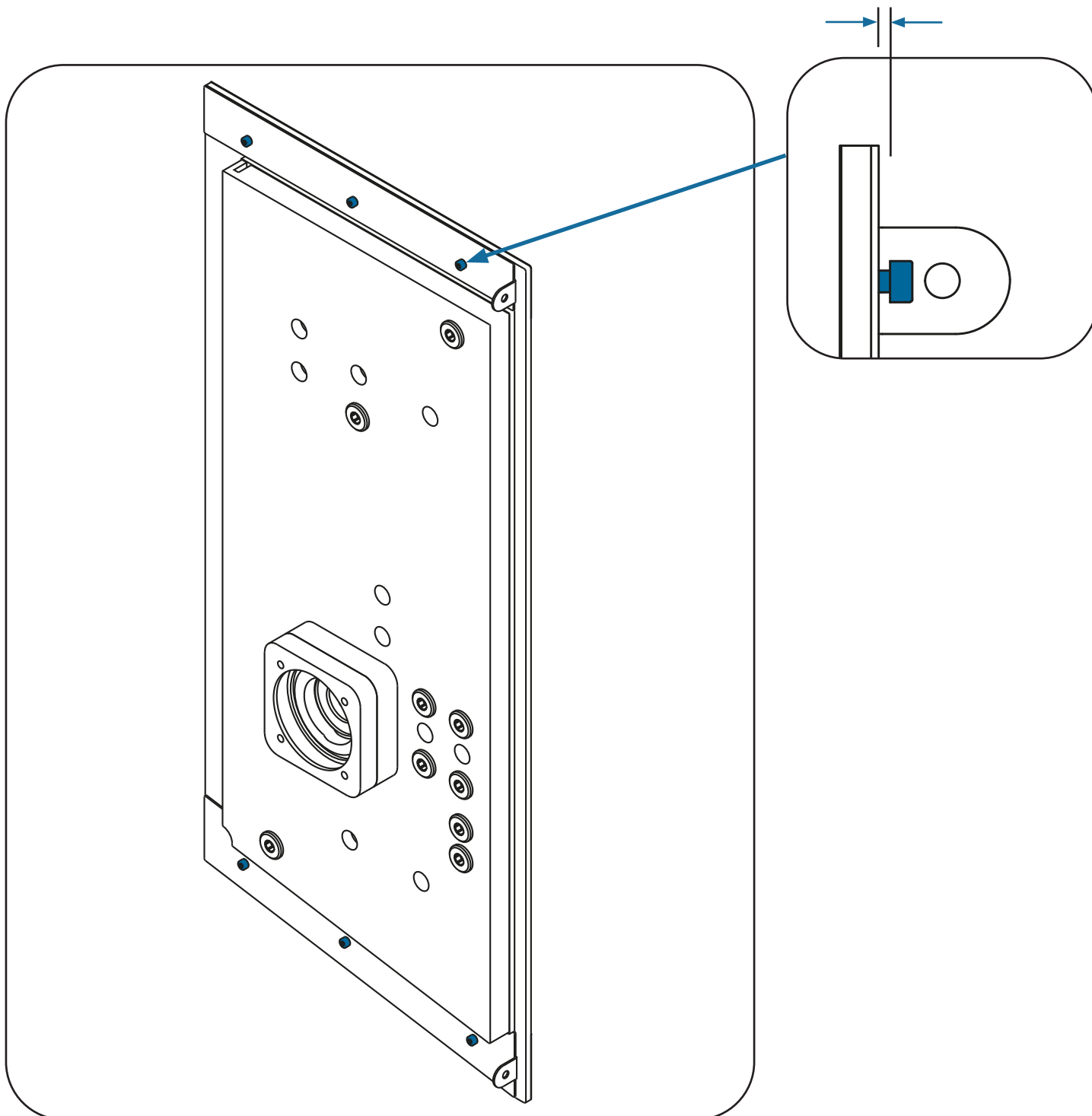

STEP 3

Insert the distro plate into the case in the same way as the original front panel, then secure it using the original screws.

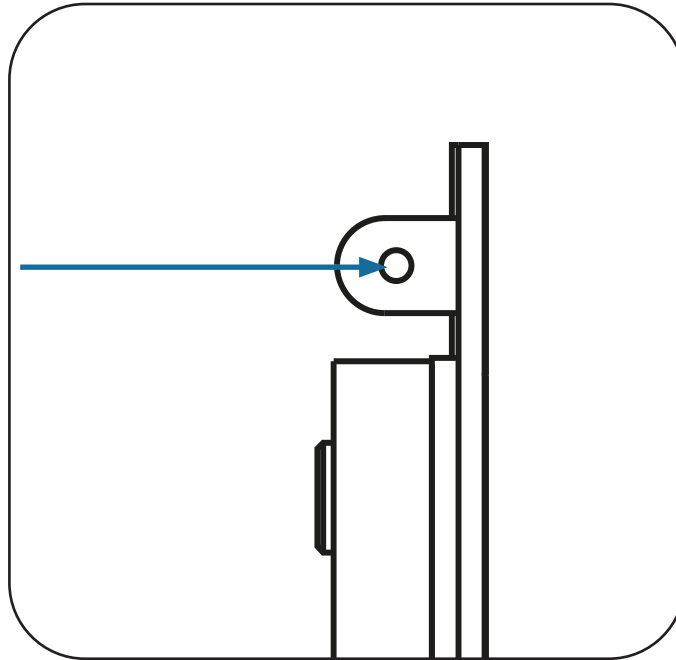

STEP 4

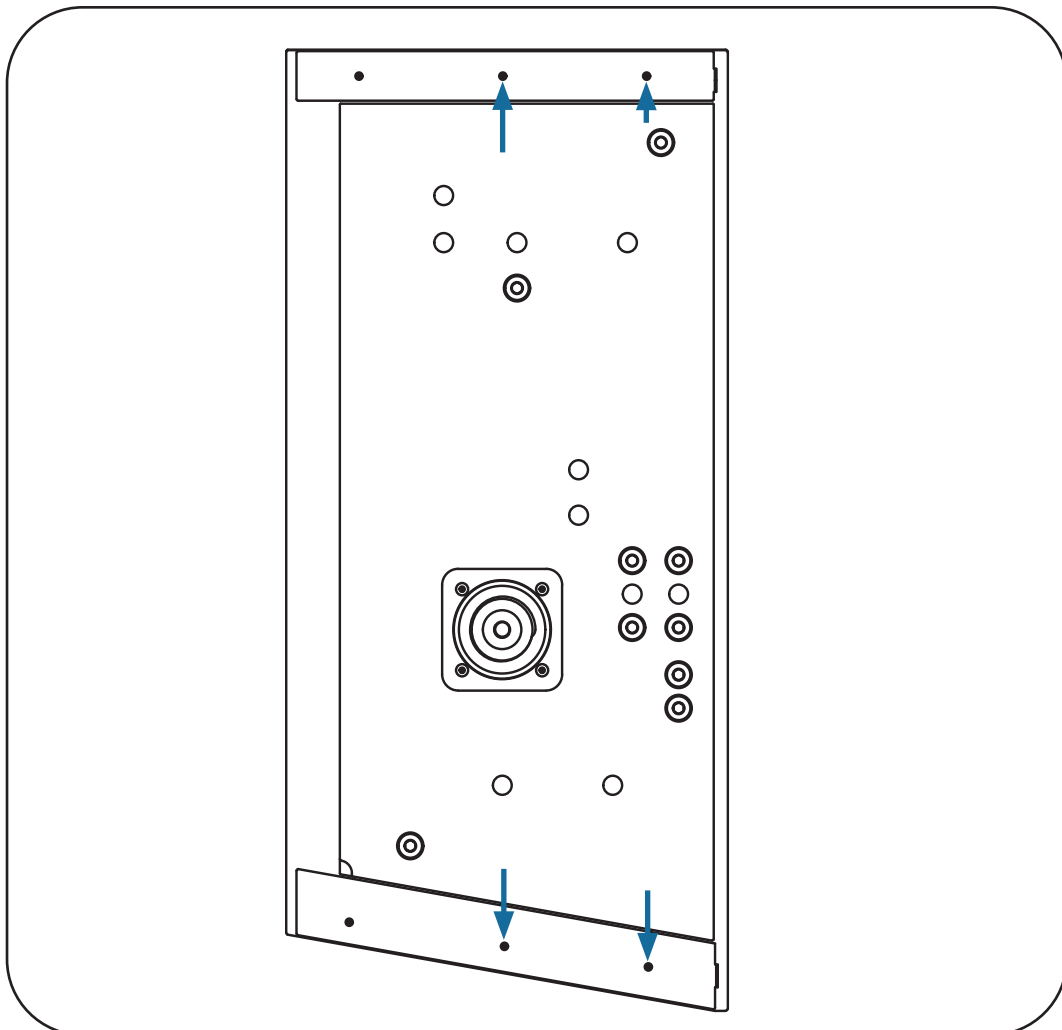
Tighten the four visible cylinder head screws at the top and bottom inside the case. A 2.5 mm Allen key is required for this step.

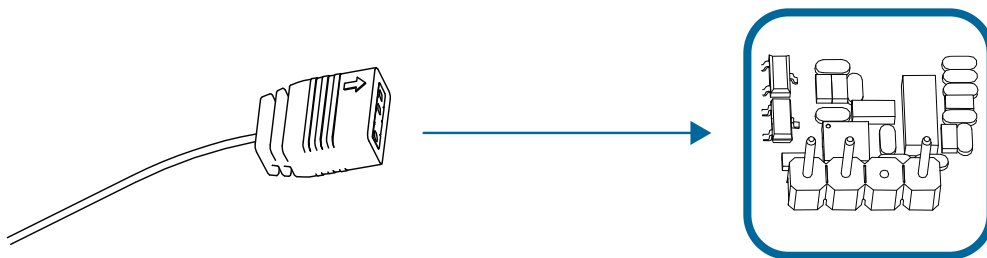

7. CONNECTING THE D-RGB CABLE

Connect the D-RGB cable to a compatible motherboard (3-Pin ARGB Connector).



8. INSTALLING THE CONNECTIONS

Mount the connections with G1/4 thread and close the remaining connections with stop fittings. Always perform a leak test before applying power to the system components (max. 0,5 bar).

Carefully loosen the shut-off valve of the filling connection to allow trapped air to escape.

9. CLEANING & CARE

Clean the distro plate only with microfiber cloths to avoid scratches in the material. Do not use cleaners containing alcohol to avoid stress cracks in the material. Before installing the distro plate, it is recommended to rinse the distro plate to remove any last residues. Acrylic paints can leave residues.

10. SUPPORT AND SERVICE

Contact

Stealkey Customs

Mail: support@stealkeycustoms.de

Instagram: <https://www.instagram.com/stealkeycustoms>

Website: <https://www.stealkeycustoms.de>

FAQ: <https://www.stealkeycustoms.de/pages/faq>

